

SUN WALLS

MODULAR WALL SYSTEM • COUNTERS • DISPLAYS • MORE



*Let Sunwalls
Get You Started!*

- Quality • Affordability
- Flexibility • Profitability

- Modular Salon, Fitting, & Privacy Rooms
- Custom Front Counters & Product Displays
- Styling Salon Stations & Accessories
- Free Salon Layout & Design Assistance

800-994-8484

WWW.SUNWALLS.COM



CREATE A SALON THAT MEANS BUSINESS!

The **Sunwalls Modular Wall System** is recognized as one of the most economical, flexible and expedient ways of interior room layout. Our design offers quick, clean assembly and re-assembly using no complicated parts and minimal components to eliminate any confusion and errors. The panels, assembled via an interlocking channel system, can be configured for an entire salon in a few hours, and because they are only 3/4" thick, you gain space compared to normal wall construction.



- Total Flexibility • Total Quality • Hundreds of Color Combinations • Free Layout & Design Service
- Salon Enhancements • Custom Displays & Counters

French Door Upgrade

\$499
per room



Sliding Door Upgrade

\$165
per room

OUTSIDE

INSIDE

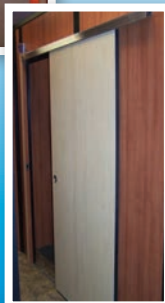

Wall Headers - Call for Pricing
(provide above wall space for low voltage wiring runs and recessed lighting.)



French Doors with LED Standoff Pillars (\$299 each) and Wall Headers

SUN WALLS

www.sunwalls.com
800-994-8484

MELAMINE WALL COLORS

YOUR CHOICE! YOUR STYLE!

LAMINATE DOOR & COUNTERTOP COLORS



HARD ROCK
MAPLE



CHOCOLATE
PEAR



ALMONDINE



COCKTAIL



BLACK

Once your salon layout is complete choose from a selection of standard color **MELAMINE** wall panels. Standard colors can save you money!

Make your salon as unique as you desire by using coordinating **LAMINATES** to customize doors, countertops and additional displays. Thousands of combinations are possible!



PEWTER
BRUSH

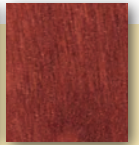

WILD
CHERRY



SATIN
STAINLESS



DESIGNER
WHITE



NATURAL
ALMOND



KENSINGTON
MAPLE

- Enhance and Accessorize your Sunwalls Salon with French Doors, Sliding Doors, Corner Benches, Slat Walls, E Chases & More Including Custom Counters, Product Displays and Fitting Rooms!



\$499
each

Curved Lobby Bench
w/5' Tall Coordinated Laminate Backdrop

E Chase



\$99
per room

\$299
each

LED Standoff
Pillar



CALL US ABOUT
2, 3, & 4 Wall
Fitting Rooms!



Choose from 8.5' x 8.5' or 10.5' x 10.5' rooms.

Custom 24" x 36" Lightbox .. \$295
Custom 24" x 36" Salon Poster .. \$30.00
Front Opening 24" x 36" Metal Frame .. \$49.00



\$89
per room

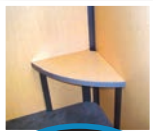

\$45
per room

Corner
Benches

\$19.99
each



Corner
Shelf

MAKE IT HAPPEN NOW!

FREE PROFESSIONAL SALON LAYOUT & DESIGN!

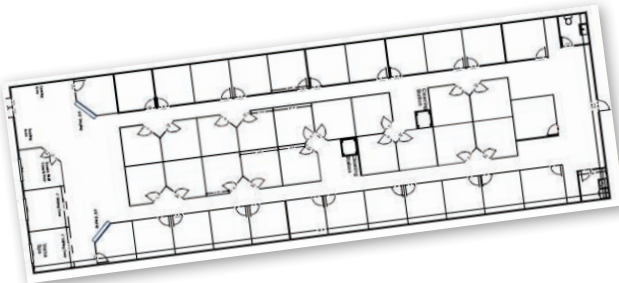

ASK US ABOUT USED WALLS!

CALL US ABOUT PACKAGE SPECIALS!



* Package price includes: Sunwalls, 32" or 36" laminated hollow core swing door, and all necessary connectors in black or almond.

Choose upgrades such as use of silver connectors or if you choose the E-chase option.

Prices may vary with choice of non-stock materials.

8' x 8' Room

8' x 10' Room

10' x 10' Room

2
WALLS

\$1,299 \$1,425 \$1,512

3
WALLS

\$1,573 \$1,776 \$1,875

4
WALLS

\$1,887 \$2,103 \$2,229

- One Room? Two? Or a Complete Salon? •
- Trust Sunwalls from Start to Finish! •



Manufactured in AMERICA

SPECIFICATIONS

PANELS: 3/4" wood composite solid substrate. All panels vertical edged to have plastic edge caps attached.

FINISH: Commercial grade melamine.

DOORS: Full height, hollow core covered in high pressure laminate to match the wall cover selection. Painted edges and pre-hung in the jamb.

DOOR FRAMES: Plastic to match connectors.

CONNECTORS: Designed to allow the panels to easily snap together and are available in Black or Silver. Silver, which projects a metallic look, can be chosen as an upgrade.

ELECTRICAL CHASES: Special connectors that allows for enclosed electrical wiring. Available in Black or Silver.

CUSTOM FRONT COUNTERS

Sunwalls Custom Counters

Counters can be custom built to your size specifications. Drawer and shelf arrangements may be customized.



Back

Quarter-Radius Counter

Starting at **\$1,649⁰⁰**

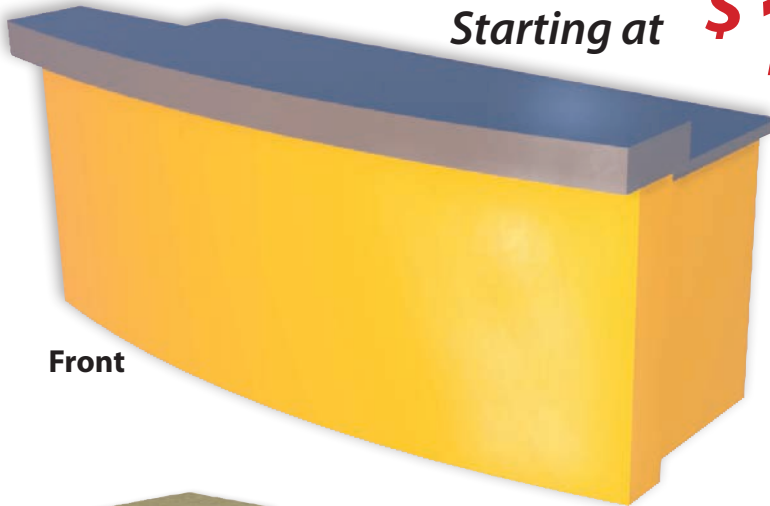

Front

with Optional Check Writing Tier **(\$150)**

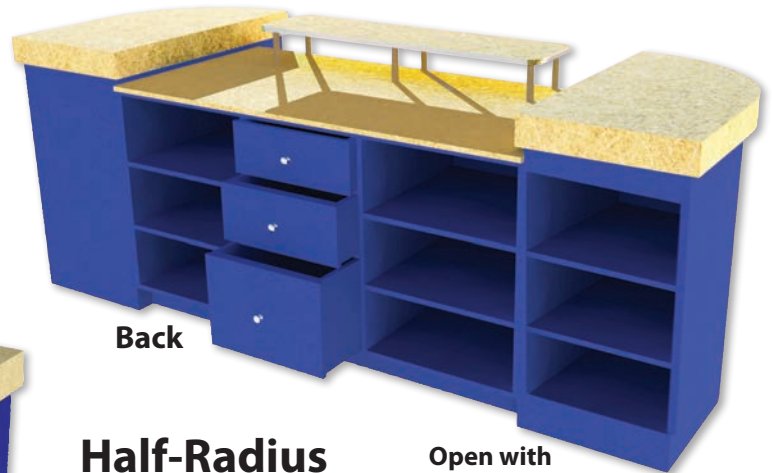

Back

Open with Shelves

Half-Radius Counter

Starting at

\$2,199⁰⁰

Choose Between
Full-Rounded
or
Front-Rounded
End Caps

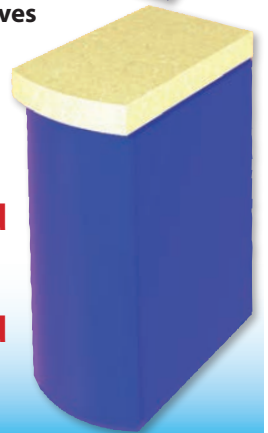

Front

with Optional Acrylic Panel with Logo **(\$299)**

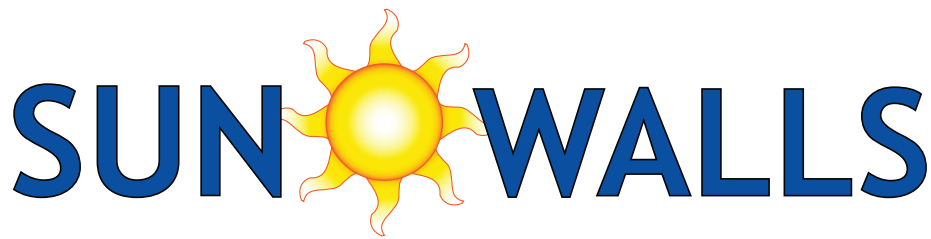

www.sunwalls.com
800-994-8484

CUSTOM FRONT COUNTERS

**Call Us for a
Quick Quote
on any Counter!**

Starting at **\$1,495⁰⁰**

Straight Counter

with Optional
Check Writing Tier **(\$150)**



with Optional
Acrylic Panel with Logo **(\$299)**



**Basket Weave
Front Counter**
w/ Optional Check Writing Tier

Starting at **\$3,349⁰⁰**

Sunwalls Custom Counters

Choose your colors to coordinate with your salon or other Sunwalls items.

We can then do a color rendering of your custom counter or display and get it to you for a quick approval.

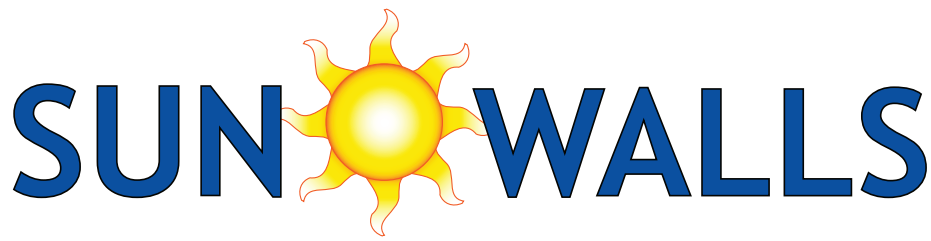

www.sunwalls.com
800-994-8484

OUR LATEST EDGE-LIT PRODUCT DISPLAYS

The "Edge Lit" Display

Eyecatching 8 LED Edge-Lit clear acrylic shelves set this design apart from other product displays. The shelves light along their edges and can be rotated between 17 colors including white.

Center acrylic uses LED standoffs that illuminate your routed logo or design at additional charge.



Starting at

\$3,349⁰⁰

LED Lighting Control Unit



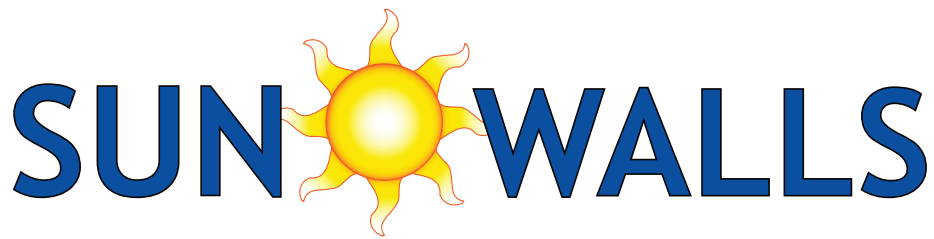

www.sunwalls.com
800-994-8484

OUR LATEST LED PANEL PRODUCT DISPLAYS



The "Curve" Display

Designed with 3 LED Curved Panel Pillars. These pillars can be rotated between 17 colors including white.

Eight glass shelves lit by overhead recessed lighting display your merchandise with illuminated elegance.

Starting at

\$2,999⁰⁰

LED Lighting Control Unit



QUARTER-RADIUS PRODUCT DISPLAYS

These displays can be custom built to your size specifications



Backlit Acrylic Option:

- Center backlit acrylic*
- 4 recessed lamps
- Glass display shelves

optional vinyl logo additional **\$299⁰⁰**

Starting at **\$1,649⁰⁰**



3-Section Shelving Option:

- 3 shelving areas • 6 recessed lamps
- Glass display shelves



Framed Poster additional **\$99⁰⁰**

additional **\$349⁰⁰** per backlit section

3-Section LED Option:

- 3 backlit LED panels*
- 3 shelving areas
- Glass display shelves



Call Us for a Quick Quote on any Display!



Color-changing LED panels can rotate between 6 shades to match any atmosphere.

Center Section Poster Option:

- 2 shelving areas
- 4 recessed lamps
- Glass display shelves

*LED backlit panels are able to change colors or remain stationary at a single color including white.

FRONT ROUNDED DISPLAYS

Starting at **\$3,249⁰⁰**



3-Section Shelving Option:

- 3 shelving areas
- 6 recessed lamps
- Glass display shelves



Backlit Acrylic Option:

- Center backlit acrylic*
- 4 recessed lamps
- Glass display shelves

optional vinyl logo additional **\$299⁰⁰**



Framed Poster 24" x 36"

additional **\$99⁰⁰**

Center Section Poster Option:

- 2 shelving areas
- 4 recessed lamps
- Glass display shelves



3-Section LED Option:

- 3 backlit LED panels*
- 3 shelving areas
- Glass display shelves

additional **\$349⁰⁰**

per backlit section

These displays can be custom built to your size specifications

*LED backlit panels are able to change colors or remain stationary at a single color including white.